

THE
FREDERICK
 | CONDOMINIUMS |

THE
GLADSTONE

1 BEDROOM + FLEX
 Interior: 614 sq.ft.

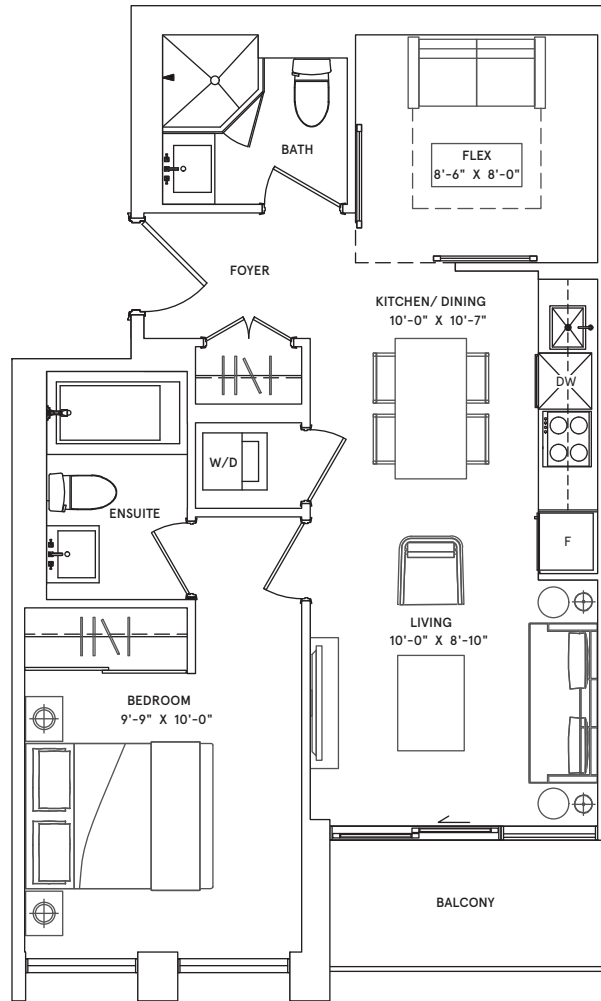

NORTH
 KEY PLAN TYPICAL
 FLOORS 10-28

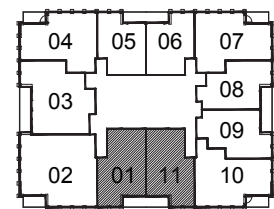

Dimensions, specifications, layouts (including but not limited to tile patterns), window sizes, mullions, fixture representation, appliance and fixture locations, and materials are approximate only, may vary, and are subject to changes without notice as provided in the Agreement of Purchase and Sale. Plans may be reversed. Wall thickness will vary with floor levels reducing room dimensions accordingly. Actual usable floor space may vary from the stated floor area. Measurements of rooms set forth on any floor plan are generally taken at the greatest points of each given room and centre line of windows (as if the room were perfectly rectangular). Furniture is not included. Furniture shown on terrace spaces should be secured for safety. Prices are subject to change without notice. E. & O.E. Plans are not to scale. For more information on the method used for calculating floor area of any unit, reference should be made to Builder Bulletin NO. 22 published by Tarion.

THE
FREDERICK
 | CONDOMINIUMS |

THE
ASTAIRE

2 BEDROOM
 Interior: 997sq.ft.

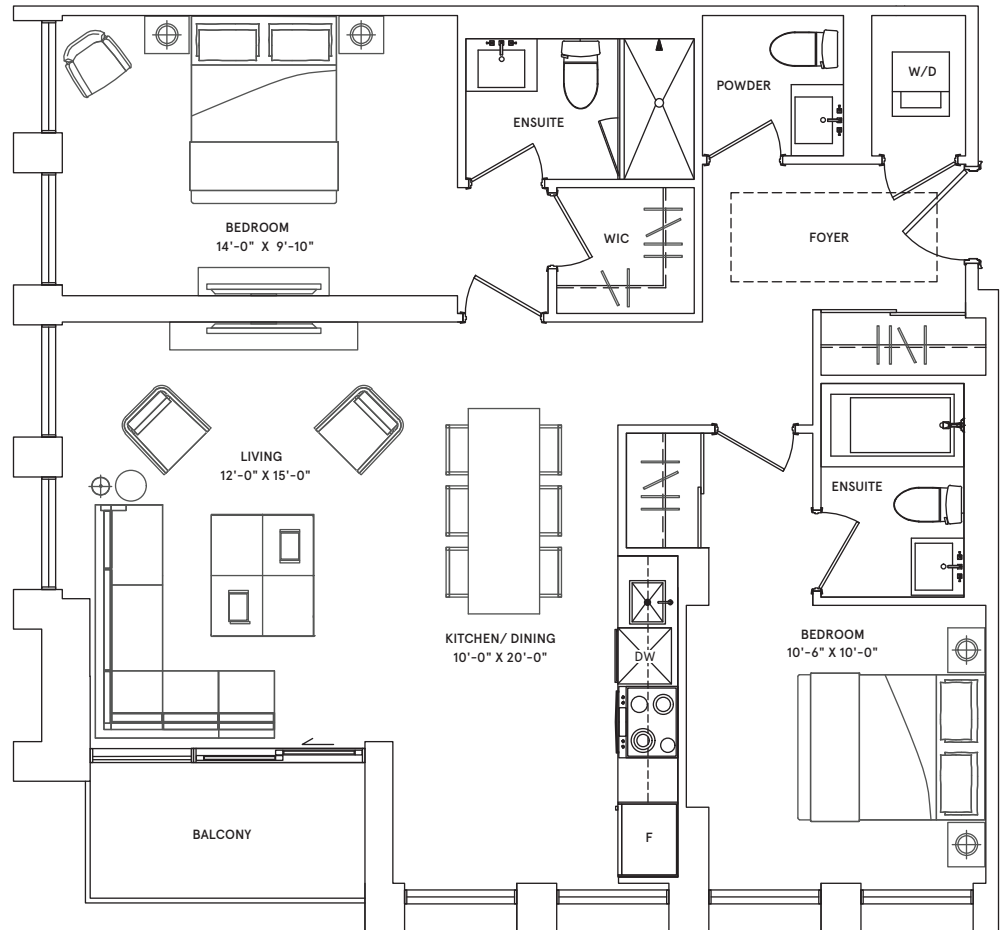

NORTH
 KEY PLAN TYPICAL
 FLOORS 10-28

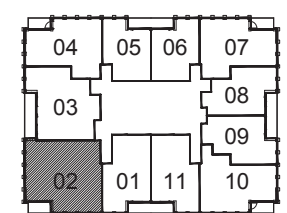

Dimensions, specifications, layouts (including but not limited to tile patterns), window sizes, mullions, fixture representation, appliance and fixture locations, and materials are approximate only, may vary, and are subject to changes without notice as provided in the Agreement of Purchase and Sale. Plans may be reversed. Wall thickness will vary with floor levels reducing room dimensions accordingly. Actual usable floor space may vary from the stated floor area. Measurements of rooms set forth on any floor plan are generally taken at the greatest points of each given room and centre line of windows (as if the room were perfectly rectangular). Furniture is not included. Furniture shown on terrace spaces should be secured for safety. Prices are subject to change without notice. E. & O.E. Plans are not to scale. For more information on the method used for calculating floor area of any unit, reference should be made to Builder Bulletin NO. 22 published by Tarion.

THE
FREDERICK
 | CONDOMINIUMS |

THE
PERRY

2 BEDROOM
 Interior: 825 sq.ft.

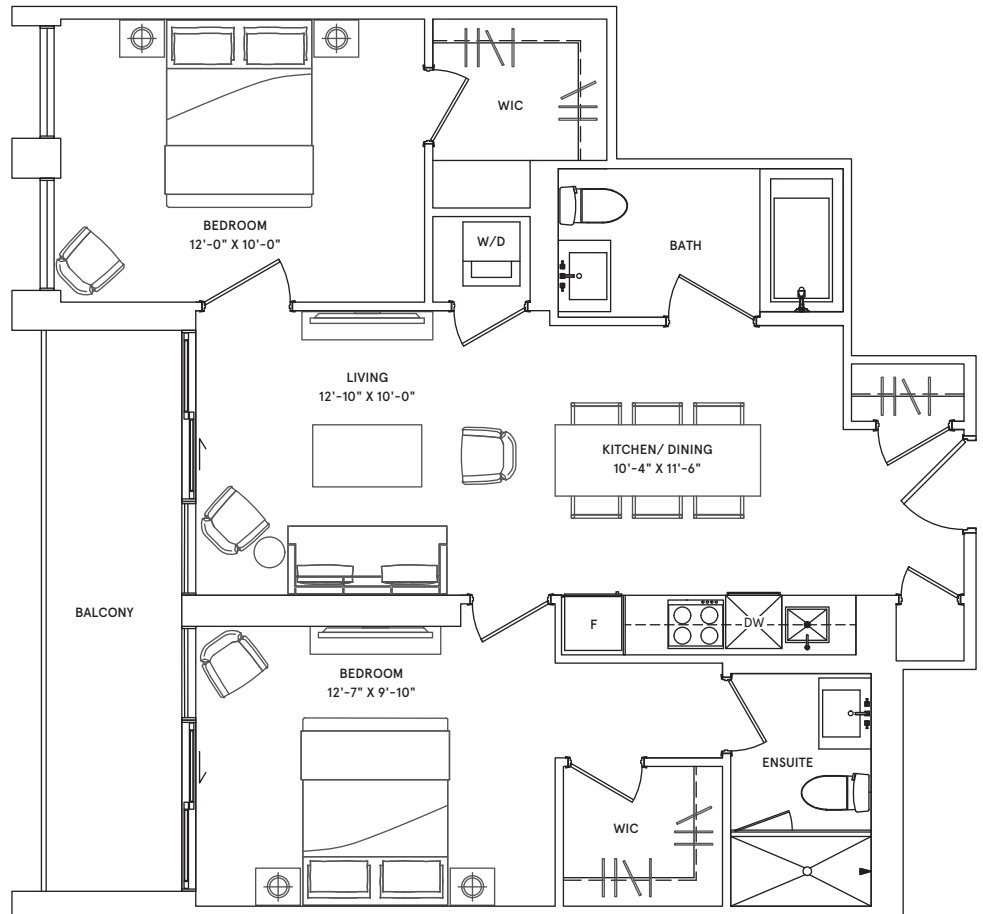

NORTH
 KEY PLAN TYPICAL
 FLOORS 10-28

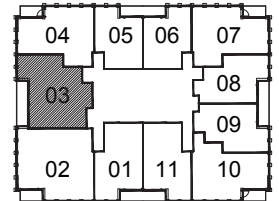

Dimensions, specifications, layouts (including but not limited to tile patterns), window sizes, mullions, fixture representation, appliance and fixture locations, and materials are approximate only, may vary, and are subject to changes without notice as provided in the Agreement of Purchase and Sale. Plans may be reversed. Wall thickness will vary with floor levels reducing room dimensions accordingly. Actual usable floor space may vary from the stated floor area. Measurements of rooms set forth on any floor plan are generally taken at the greatest points of each given room and centre line of windows (as if the room were perfectly rectangular). Furniture is not included. Furniture shown on terrace spaces should be secured for safety. Prices are subject to change without notice. E. & O.E. Plans are not to scale. For more information on the method used for calculating floor area of any unit, reference should be made to Builder Bulletin NO. 22 published by Tarion.

THE
FREDERICK
 | CONDOMINIUMS |

THE
MERCURY

2 BEDROOM
 Interior: 715 sq.ft.

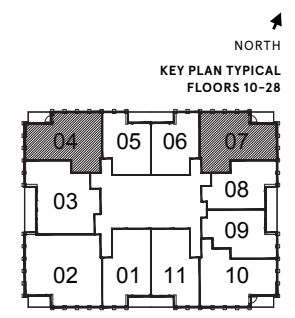
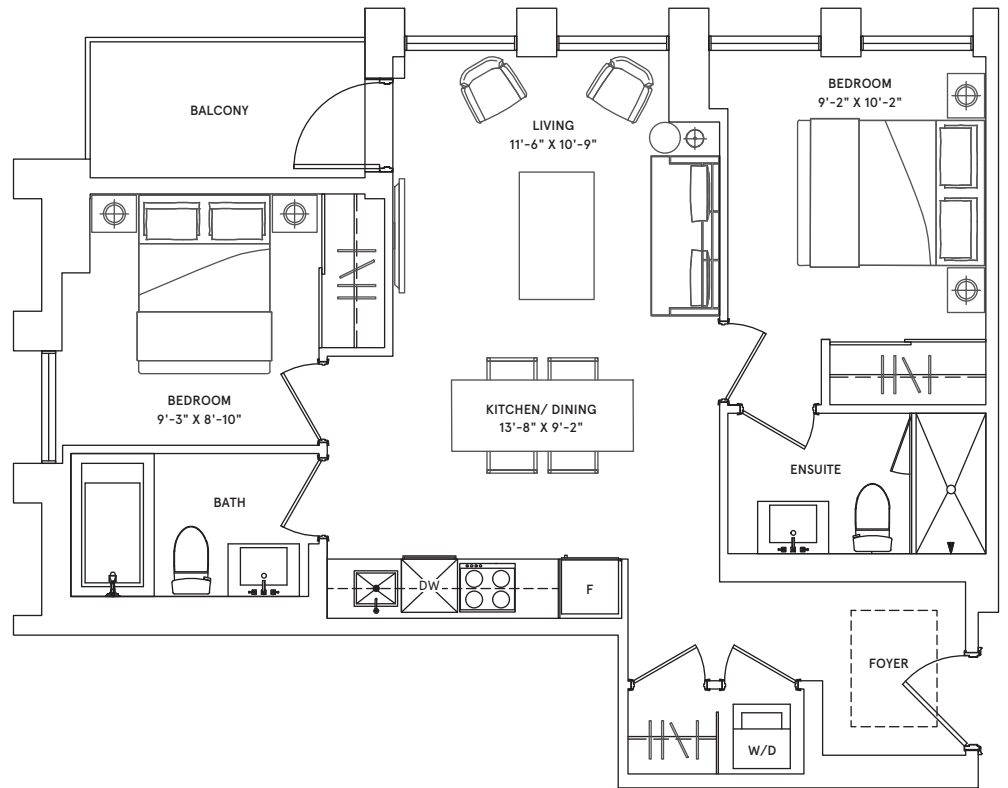

Dimensions, specifications, layouts (including but not limited to tile patterns), window sizes, mullions, fixture representation, appliance and fixture locations, and materials are approximate only, may vary, and are subject to changes without notice as provided in the Agreement of Purchase and Sale. Plans may be reversed. Wall thickness will vary with floor levels reducing room dimensions accordingly. Actual usable floor space may vary from the stated floor area. Measurements of rooms set forth on any floor plan are generally taken at the greatest points of each given room and centre line of windows (as if the room were perfectly rectangular). Furniture is not included. Furniture shown on terrace spaces should be secured for safety. Prices are subject to change without notice. E. & O.E. Plans are not to scale. For more information on the method used for calculating floor area of any unit, reference should be made to Builder Bulletin NO. 22 published by Tarion.

THE
FREDERICK
 | CONDOMINIUMS |

THE
 COUPLES

1 BEDROOM

Interior: 498 sq.ft.

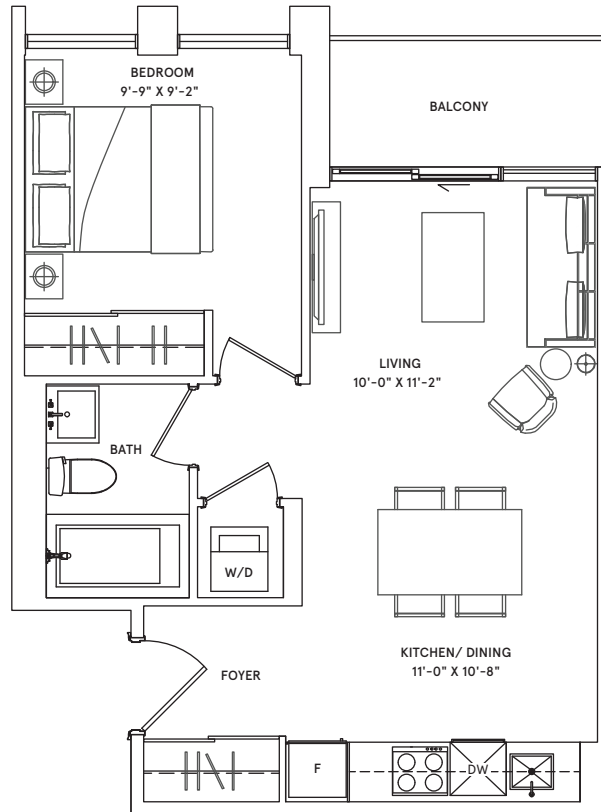

NORTH
 KEY PLAN TYPICAL
 FLOORS 10-28

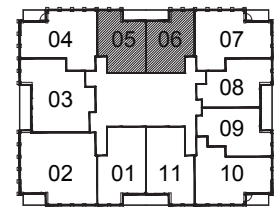

Building Excellence

Dimensions, specifications, layouts (including but not limited to tile patterns), window sizes, mullions, fixture representation, appliance and fixture locations, and materials are approximate only, may vary, and are subject to changes without notice as provided in the Agreement of Purchase and Sale. Plans may be reversed. Wall thickness will vary with floor levels reducing room dimensions accordingly. Actual usable floor space may vary from the stated floor area. Measurements of rooms set forth on any floor plan are generally taken at the greatest points of each given room and centre line of windows (as if the room were perfectly rectangular). Furniture is not included. Furniture shown on terrace spaces should be secured for safety. Prices are subject to change without notice. E. & O.E. Plans are not to scale. For more information on the method used for calculating floor area of any unit, reference should be made to Builder Bulletin NO. 22 published by Tarion.

THE
FREDERICK
 | CONDOMINIUMS |

THE
HIGHMORE

1 BEDROOM + DEN
 Interior: 546 sq.ft.

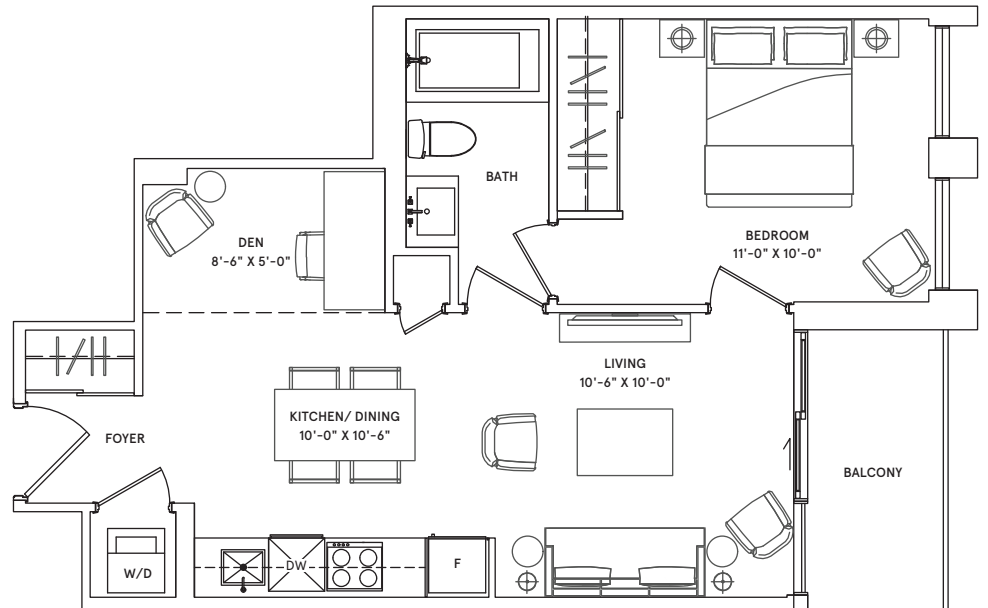

NORTH
 KEY PLAN TYPICAL
 FLOORS 10-28

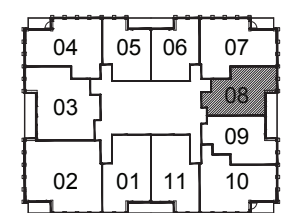

Dimensions, specifications, layouts (including but not limited to tile patterns), window sizes, mullions, fixture representation, appliance and fixture locations, and materials are approximate only, may vary, and are subject to changes without notice as provided in the Agreement of Purchase and Sale. Plans may be reversed. Wall thickness will vary with floor levels reducing room dimensions accordingly. Actual usable floor space may vary from the stated floor area. Measurements of rooms set forth on any floor plan are generally taken at the greatest points of each given room and centre line of windows (as if the room were perfectly rectangular). Furniture is not included. Furniture shown on terrace spaces should be secured for safety. Prices are subject to change without notice. E. & O.E. Plans are not to scale. For more information on the method used for calculating floor area of any unit, reference should be made to Builder Bulletin NO. 22 published by Tarion.

THE
FREDERICK
 | CONDOMINIUMS |

THE
COLE

1 BEDROOM + DEN
 Interior: 562 sq.ft.

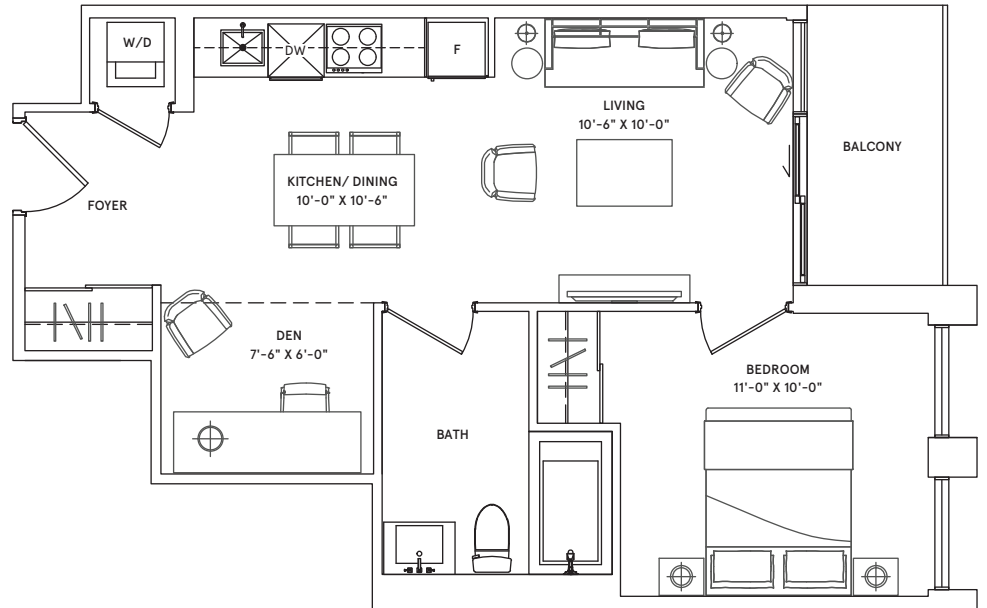

NORTH
 KEY PLAN TYPICAL
 FLOORS 10-28

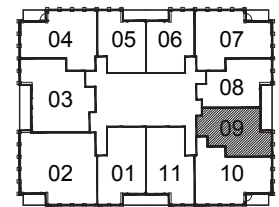

Dimensions, specifications, layouts (including but not limited to tile patterns), window sizes, mullions, fixture representation, appliance and fixture locations, and materials are approximate only, may vary, and are subject to changes without notice as provided in the Agreement of Purchase and Sale. Plans may be reversed. Wall thickness will vary with floor levels reducing room dimensions accordingly. Actual usable floor space may vary from the stated floor area. Measurements of rooms set forth on any floor plan are generally taken at the greatest points of each given room and centre line of windows (as if the room were perfectly rectangular). Furniture is not included. Furniture shown on terrace spaces should be secured for safety. Prices are subject to change without notice. E. & O.E. Plans are not to scale. For more information on the method used for calculating floor area of any unit, reference should be made to Builder Bulletin NO. 22 published by Tarion.

THE
FREDERICK
 | CONDOMINIUMS |

THE
BANTING

2 BEDROOM
 Interior: 725 sq.ft.

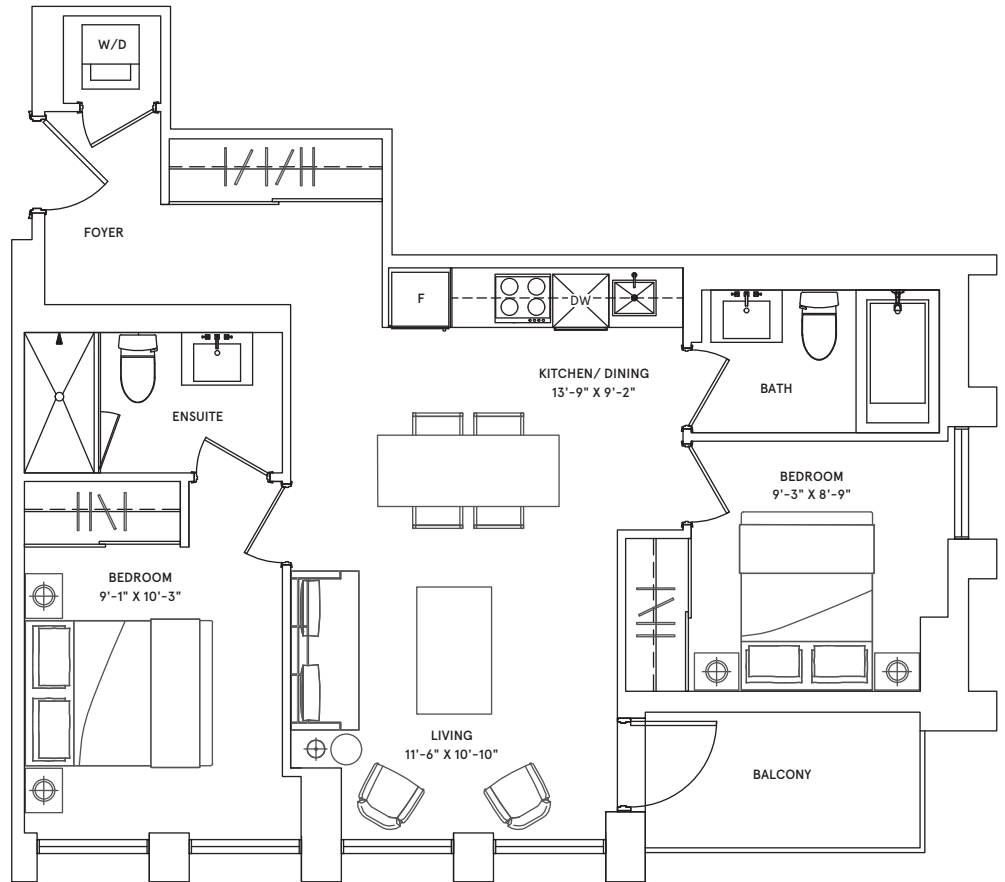

NORTH
 KEY PLAN TYPICAL
 FLOORS 10-28

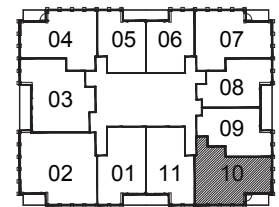

Dimensions, specifications, layouts (including but not limited to tile patterns), window sizes, mullions, fixture representation, appliance and fixture locations, and materials are approximate only, may vary, and are subject to changes without notice as provided in the Agreement of Purchase and Sale. Plans may be reversed. Wall thickness will vary with floor levels reducing room dimensions accordingly. Actual usable floor space may vary from the stated floor area. Measurements of rooms set forth on any floor plan are generally taken at the greatest points of each given room and centre line of windows (as if the room were perfectly rectangular). Furniture is not included. Furniture shown on terrace spaces should be secured for safety. Prices are subject to change without notice. E. & O.E. Plans are not to scale. For more information on the method used for calculating floor area of any unit, reference should be made to Builder Bulletin NO. 22 published by Tarion.