



# HIGHLAND COMMONS

RESIDENCES BY THE CREEK

## WHAT SETS HIGHLAND COMMONS APART





# LIVE. CONNECT. ESCAPE.

Two mid-rise condominium buildings in the Highland Creek neighbourhood of East Toronto.

Introducing Highland Commons, where a modern living experience is paired with curated amenities and the charm of a historic neighbourhood.



BUILDING EXTERIOR

## BUILDING FACTS

- ⌄ Over 10,000 square feet of indoor amenities
- ⌄ Over 19,000+ square feet of outdoor amenities
- ⌄ 18 indoor & outdoor amenities for residents to enjoy
- ⌄ 8 storeys per building
- ⌄ Phase 1- 263 suites  
Phase 2- 276 suites

### Indoor amenities

- Lobby
- Social Club
- Co-working Space
- Fitness Centre
- Squash Court
- Games Room
- Kids Centre
- Guest Suites
- Pet Wash
- Parcel Room
- Change Rooms

### Outdoor amenities

- Outdoor Pool
- Outdoor Games
- BBQ Dining Area
- Outdoor Pool & Showers
- Life-sized Chess Set
- Basketball Court
- Resident Garden Area
- Rooftop Amenity



# ENJOY THE CHARM OF LIVING LOCALLY AT HIGHLAND COMMONS

Get more square feet while living in the 416.

### Price per square foot (PSF)

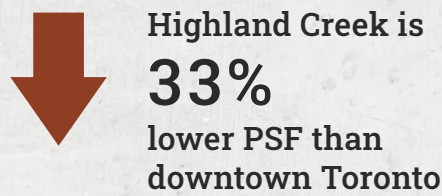

### Rent vs own\*\*

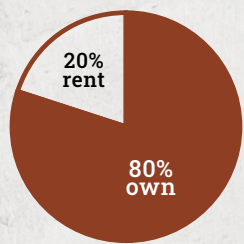

### Highland Creek

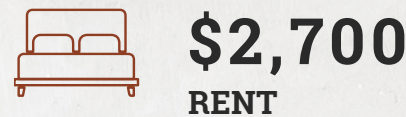
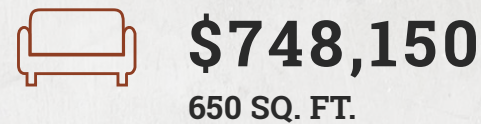

### Downtown Toronto

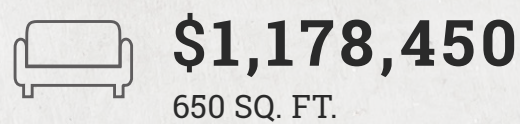

PSF and rent numbers from Urbanation, RealNet, and TREB Reporting.

\*\*Information taken from Highland Creek/Scarborough Rouge Neighbourhoods 2016 Census

LIGHT-FILLED ROOMS  
ILLUMINATE YOUR DAYS.







# HIGHLAND CREEK/ SCARBOROUGH ROUGE NEIGHBOURHOOD STATS



**102,275**

Population

Current preconstruction  
inventory around  
Highland Commons



**25-45**

Average age\*

**84% SOLD**

Average Household Income\*

Highland Creek

Toronto

**\$ \$109,498**

**\$ \$102,721**

\*Information taken from Highland Creek/Scarborough Rouge Neighbourhoods 2016 Census

SCARBOROUGH PROPERTY VALUES  
WERE UP **25%** IN MARCH 2022  
COMPARED TO MARCH 2021

\*\*Taken from Wowa Toronto Housing Report for March 2022.



OUTDOOR GAMES AREA



# PROJECT HIGHLIGHTS



Outdoor amenity spaces including pool, dining area, and basketball court



Lobby with dedicated parcel storage and 24/7 concierge



BBQ dining area with lounge seating and fire pits



Two level Fitness Centre with weights, cardio equipment and spin area



From studio to one, two, and three bedroom suites



Dynamic indoor and outdoor child-friendly spaces including Kids' Room and life-sized chess set



**Direct shuttle service to Guildwood GO Station exclusive to all residents**



Ontario's population is projected to increase by **35.8%**, or almost **5.3 million**, over the next 26 years, from an estimated 14.7 million on July 1, 2020 to over **20.0 million** by July 1, 2046\*.

The Greater Toronto Area (GTA) is projected to be the fastest growing region, with its population increasing by **2.9 million**, or **40.9%**, from 7.1 million in 2020 to almost **10.0 million** by 2046.

The GTA's share of provincial population is projected to rise from **48.0%** in 2020 to **49.8%** in 2046\*.

\*from Ontario.ca website





AMENITY SITE PLAN



Resident Mailboxes



Outdoor BBQ Area



Kids' Centre



24/7 Concierge



Outdoor Dining Area



Games Room



Parcel Delivery Area



Outdoor Pool



Basketball Court

1

Outdoor Chess

2

Outdoor BBQ Area

3

Outdoor Dining Area

4

Basketball Court

5

Ping Pong Table

6

Squash Court

7

Co-working Space

8

Party Room

9

Kids' Centre

10

Lobby

11

Pet Wash

12

Parcel Room

13

Change Rooms

14

Fitness Centre

15

Outdoor Showers

16

Outdoor Pool

17

Guest Suites

18

Planting Area





ENJOY WORKOUTS  
THAT FIT YOUR  
SCHEDULE

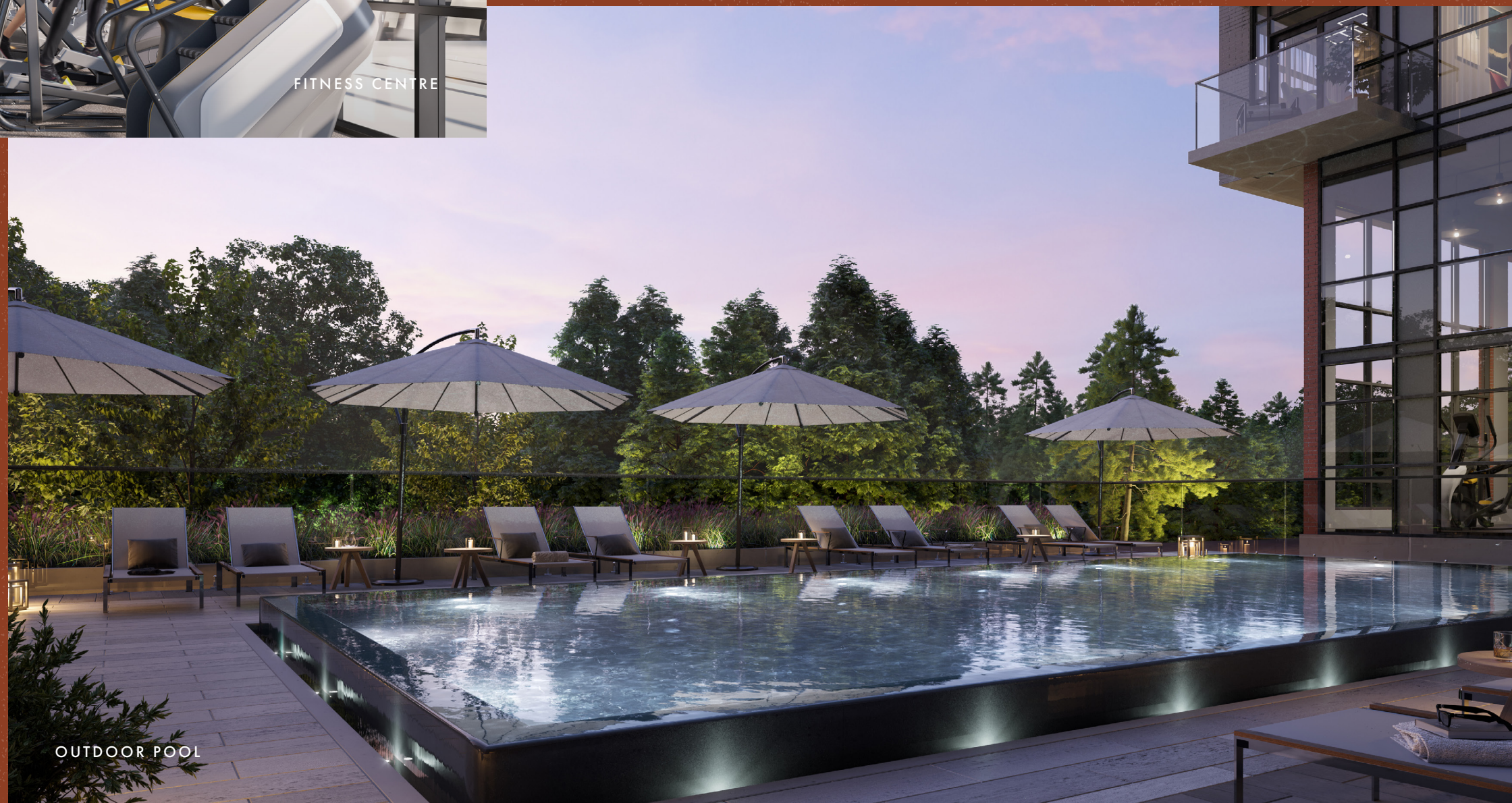



# AREA MAP

Highland Commons is East Toronto's next big hit. Here are just a few of the reasons this area is slated for substantial development in the next decade.

- Drive to downtown Toronto in **30** minutes
- Get to Union Station in **30** minutes via the GO Train
- Drive to Pearson Airport in **30** minutes

- 5 minutes to Highway 401
- 7 minutes to Guildwood GO Station
- 4 minutes to Toronto Pan Am Sports Centre
- 3 minutes to U of T Scarborough Campus
- Colonel Danforth Park & ravine at your doorstep
- 6 minutes to East Point Park & Scarborough Bluffs
- 10 minutes to Scarborough Town Centre
- 7 minutes to Toronto Zoo



## SCHOOLS

- 1 Highland Creek Public School
- 2 Meadowvale Public School
- 3 Military Trail Public School
- 4 Cardinal Leger Catholic Secondary School
- 5 St. John Paul II Catholic Secondary School
- 6 West Hill Collegiate Institute
- 7 Sir Oliver Mowat Collegiate Institute

## POST-SECONDARY

- 8 University of Toronto Scarborough Campus
- 9 Centennial College Progress Campus
- 10 Centennial College Morningside Campus

## SHOPS

- 1 Scarborough Town Centre
- 2 Shops at Highland Creek
- 3 The Villages of Abbey Lane
- 4 LCBO
- 5 Shoppers Drug Mart
- 6 Food Basics
- 7 M&M Food Market
- 8 Coppa's Fresh Market
- 9 Walmart

## RECREATION

- 1 Toronto Pan Am Sports Centre
- 2 Cineplex Odeon Morningside Cinemas
- 3 Scarboro Golf and Country Club
- 4 Toronto Zoo
- 5 Heron Park Community Centre

## PARKS

- 1 Highland Creek Park
- 2 Morningside Park
- 3 Colonel Danforth Park
- 4 Guild Park & Gardens
- 5 Bluffers Park and Beach
- 6 Heron Park

## CAFES & RESTAURANTS

- 1 Starbucks
- 2 Freshii
- 3 Shoeless Joe's Sports Grill
- 4 The Keg Steakhouse + Bar
- 5 Sunset Grill
- 6 Kelseys Original Roadhouse
- 7 Miller Lash House

## TRANSPORTATION

- 8 Shamrock Burgers
- 9 Northern Smokes
- 10 Six Social TO
- 11 Creek Coffee & Co
- 12 Fratelli Village Pizzeria
- 13 Highland Harvest
- 14 Krispy Kreme
- 1 Rouge Hill GO
- 2 Guildwood GO
- Olympic Trail
- Bus Routes
- GO Train route
- Future shuttle service



Direct shuttle service to Guildwood  
GO Station exclusive to all residents





## DEVELOPER

As a full-service development company, Altree provides unmatched insight, expertise, and service throughout the full spectrum of development – from strategic acquisition to planning, construction, sales and marketing, finance structuring, tax and legal processes. By consistently going above and beyond expectations and identifying opportunities to enhance neighbourhoods and connect communities, Altree is unparalleled in the creation of iconic projects that branch out from the ordinary.



OUTDOOR DINING AREA



## SALES

Hirsch + Associates is a full-service real estate firm delivering Toronto exceptional experience for over 15 years. We guide the city's most prominent developers in all steps of the process, bringing projects to life with comprehensive industry expertise and a passion for innovation. From new master-planned communities to high-rise condominiums and everything in between, the Hirsch team leads every unique sales program with individualized creative ideation followed by flawless execution. With over 7,800+ units sold, \$4.4+ billion in sales, and 34+ successful projects tactically led from inception to completion, our greatest pride is achieving success for our clients and buyers alike.



## ARCHITECTS

Specializing in a range of multi-unit residential and commercial buildings – low-rise, midrise and high-rise – Kohn offers a unique mix of technical and creative expertise that engages with existing communities while appealing to buyers. We have designed mixed-use, residential, retail and commercial projects ranging from large suburban developments to dense urban infill projects including revitalized historical buildings.



## INTERIOR DESIGN

DesignAgency is an award-winning international design studio that draws on over two decades of expertise in interior design, architectural and landscape conceiving, strategic branding, and visual communications. Key to our success is the strength of collaboration. Our talented design teams are informed by curiosity, international perspectives, and a drive for innovation. Working across hospitality, residential, commercial, and retail sectors, we work with our clients and with local and international artists, craftspeople, and suppliers to realize extraordinary experiences and lasting value.



## MARKETING

Gladstone Media is a boutique creative advertising and multimedia production agency based in Toronto. The agency provides strategic marketing solutions that are meaningful and effective, helping brands to stand out and connect with their audiences. Gladstone Media's dynamic team provides unique insights and diverse skillsets in the areas of strategy and planning, design and production, digital and social, and targeted marketing communications.





ALTREE

Brokers protected. Illustrations are artist's concept. Specifications are subject to change without notice. Altree Developments Inc., Hirsch & Associates, and their affiliates do not guarantee the accuracy of the information contained herein. E.&O.E. May 2022