



The Georgian

The Georgian

GERRARD + PARLIAMENT

THE GEORGIAN
GERRARD +
PARLIAMENT
THE GRANDEUR AND
THE GLAMOUR OF
DOWNTOWN LIFE.

The Georgian

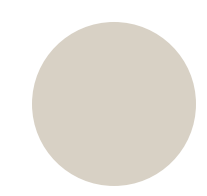

For those who love the city for its energy and glamour, here's a condominium residence destined to offer something unexpectedly grand and vibrant. Emerging on Gerrard Street East at the southern tip of colourful and eclectic Cabbagetown, The Georgian offers urban-minded home seekers a beautifully polished, classically inspired building purveying the luxe of contemporary living surrounded by transit, shopping and the grandeur of downtown Toronto.



COLOURFUL
AND ECLECTIC
CABBAGETOWN



STAFFORD







Designed by **RAW**
and with interior
spaces polished by
U31, The Georgian
is an urban
condominium that
fits into the
South Cabbagetown
landscape like
the proverbial
glove. Intimate,
just 7-storeys and
only **107 finely
crafted suites**



in 1, 2 and
3-bedroom
configurations,
here is a rare
opportunity to
live in the heart
of Toronto's
eastern downtown
within a serene
setting just
moments from
the City's
most intriguing
attractions.



Upscale and conveniently located amidst parks and transit, The Georgian was designed to immediately belong to the neighbourhood. No jarring skyscraper here, but an intimate mid-rise building with elevated architecture that reflects the charm of the community.



The neighbourhood is a vibrant, multi-cultural hub with a wide range of amenities in an area that has been designated for growth and revitalization.





Here's a place to move, a place to quench your curiosity for urban delights and to begin your love of all things downtown – like 15-minute commutes. Flanked by north side Bloor-bound Parliament and Sherbourne, The Georgian is just a stone's throw from the Financial District, a zip away from the hip communities of King, Queen and Leslieville, a bike away from your plant-based brunch and Little India curry buffet.

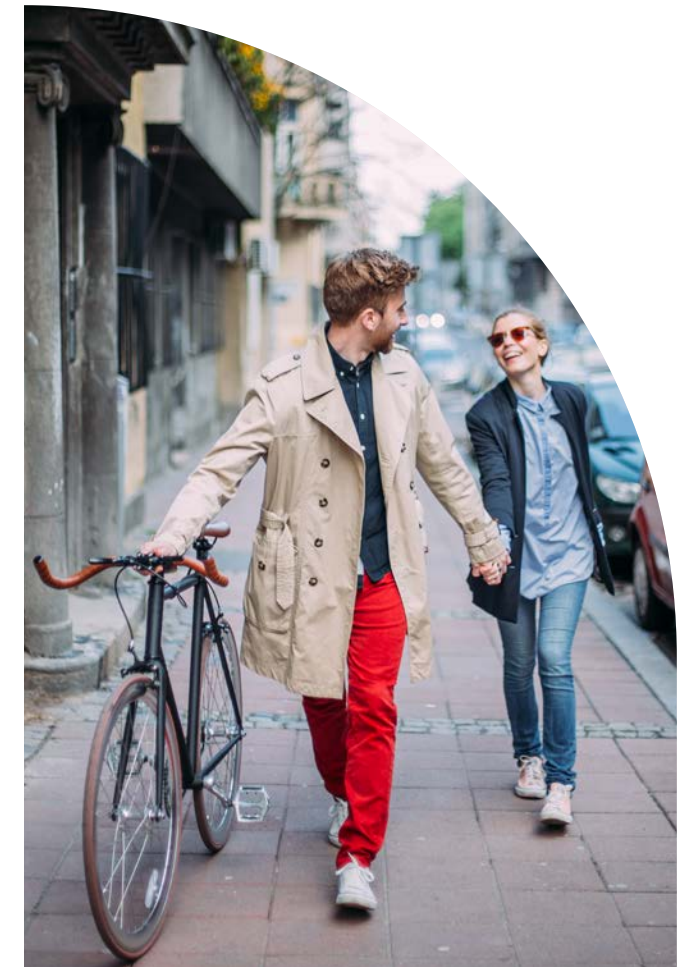

A place to live, get engaged, grow a family, and where the "it" things to do become your lifestyle. A place of heritage roots that, revitalized by today's regenerative urban vision, is about to sprout anew.

Just 2 minutes from The Georgian, you can hop a bus at Sherbourne and Gerrard to anywhere! A fast 13-minute walk takes you to Dundas Station where the TTC subway can whisk you to points north or south, connecting you to the vast transit system of Toronto and beyond.

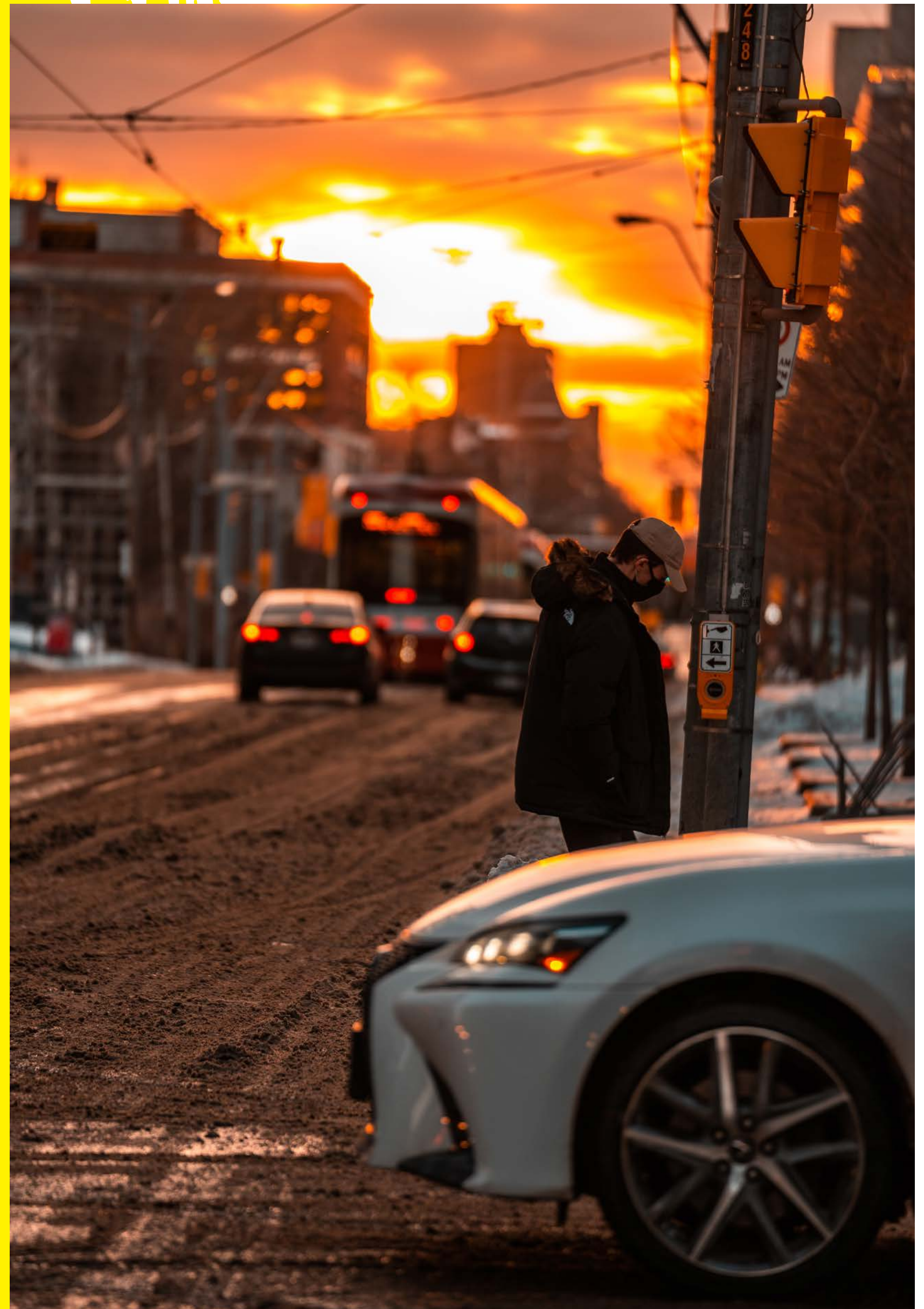



SAY HELLO
TO YOUR
NEW HOME

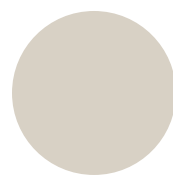

LOBBY
An urban welcome uniquely designed
to greet residents and guests in
contemporary style.



ROOFTOP TERRACE

From here or your south facing suite, the vista of Toronto's cherished panorama spreads out under a carpet of twinkling lights and stars; an apt place to enjoy the spectacle of a city bursting with growth as the opportunity to entertain or simply chill out with friends and neighbours is a short elevator ride away.

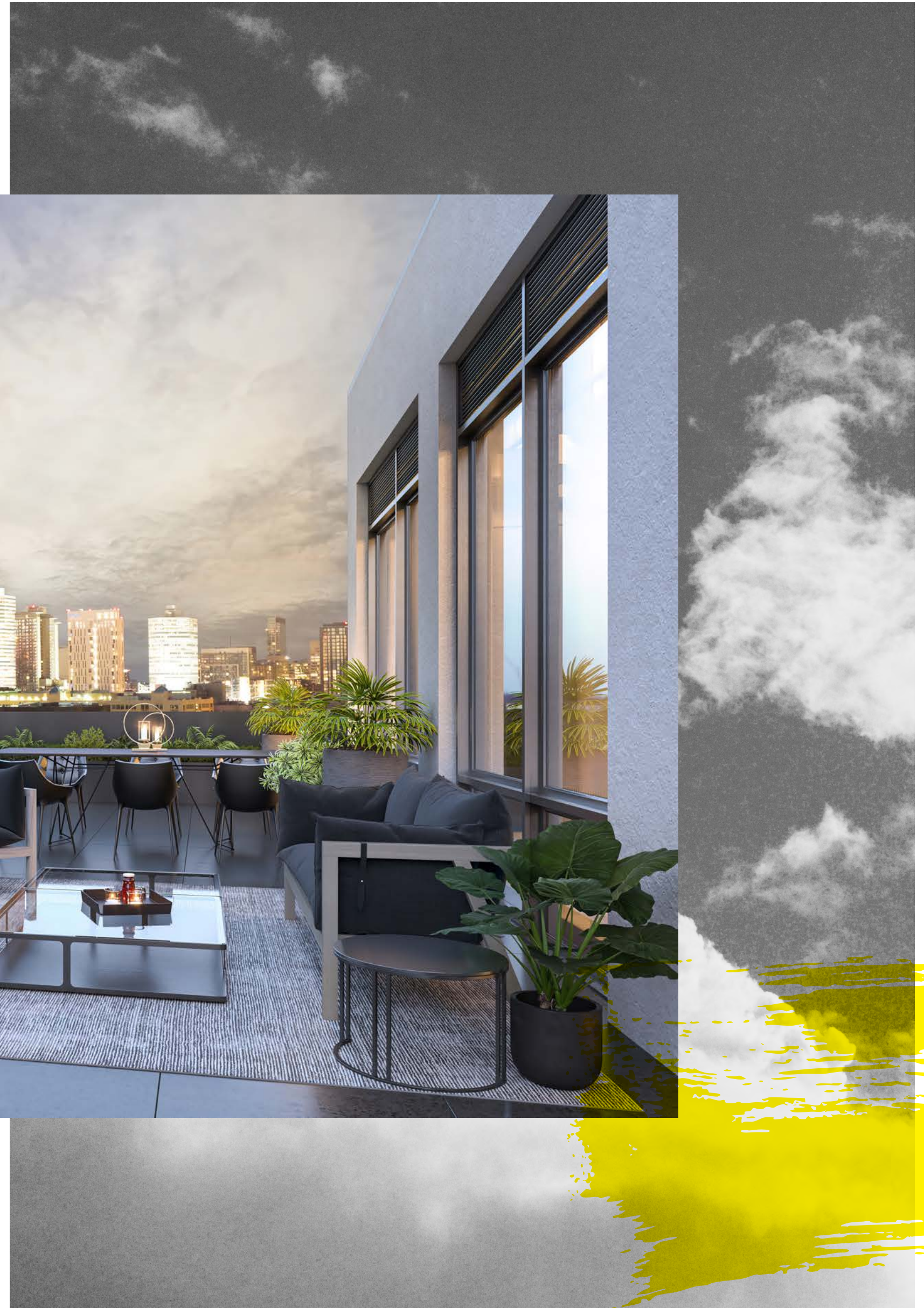

A fully-equipped Fitness Centre and
Yoga Studio offers convenience for
your workouts right at your doorstep!





SOCIAL LOUNGE
 This elegantly designed space offers a convenient venue for entertaining. Outfitted with comfortable furnishings, exquisite views, and a working kitchen, it's the ideal place to host friends and family.



CO-WORKING SPACE
 With a dedicated Co-working Space, furnished with hi-speed Wi-Fi, comfortable seating and ample work surfaces, working from home is easy and enjoyable. The beautiful views of the city compliment the truly elegant design of this light-filled, airy space.

ROOFTOP AMENITIES



AMENITIES

ROOFTOP

- 1 Pet Playground
- 2 Universal Washroom
- 3 Co-working Space
- 4 Social Lounge
- 5 BBQ Area
- 6 Rooftop Terrace

GROUND

- 1 Vestibule
- 2 Lobby
- 3 Universal Washroom
- 4 Fitness Centre
- 5 Yoga & Stretch Studio

GROUND FLOOR AMENITIES

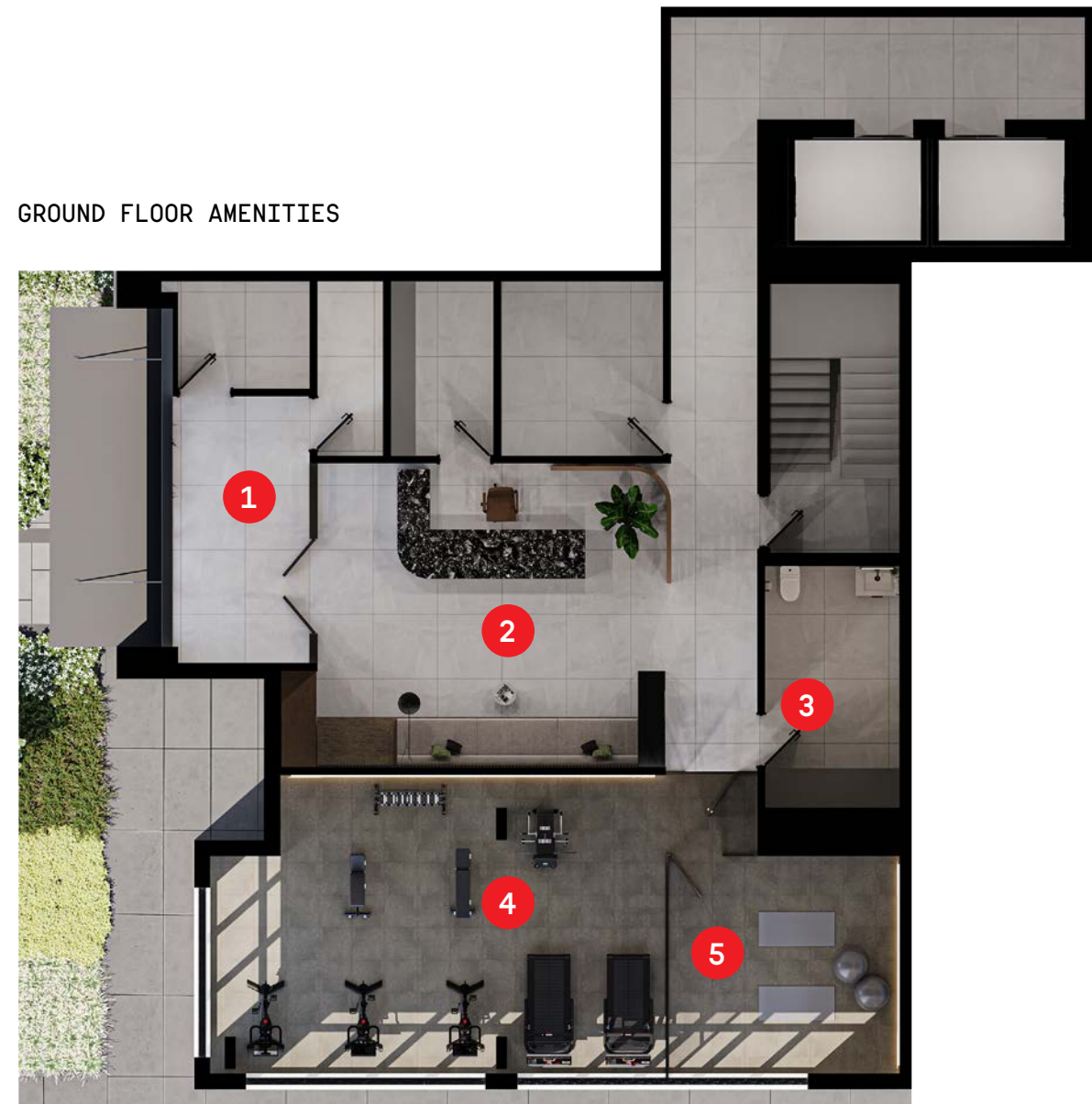

Your Kitchen is designed for efficiency and beauty; spectacularly outfitted with contemporary appliances, stone countertops and fashionable backsplash.





LUXURY IS AN ENSUITE BATHROOM CURATED FOR THE ULTIMATE IN PAMPERING.



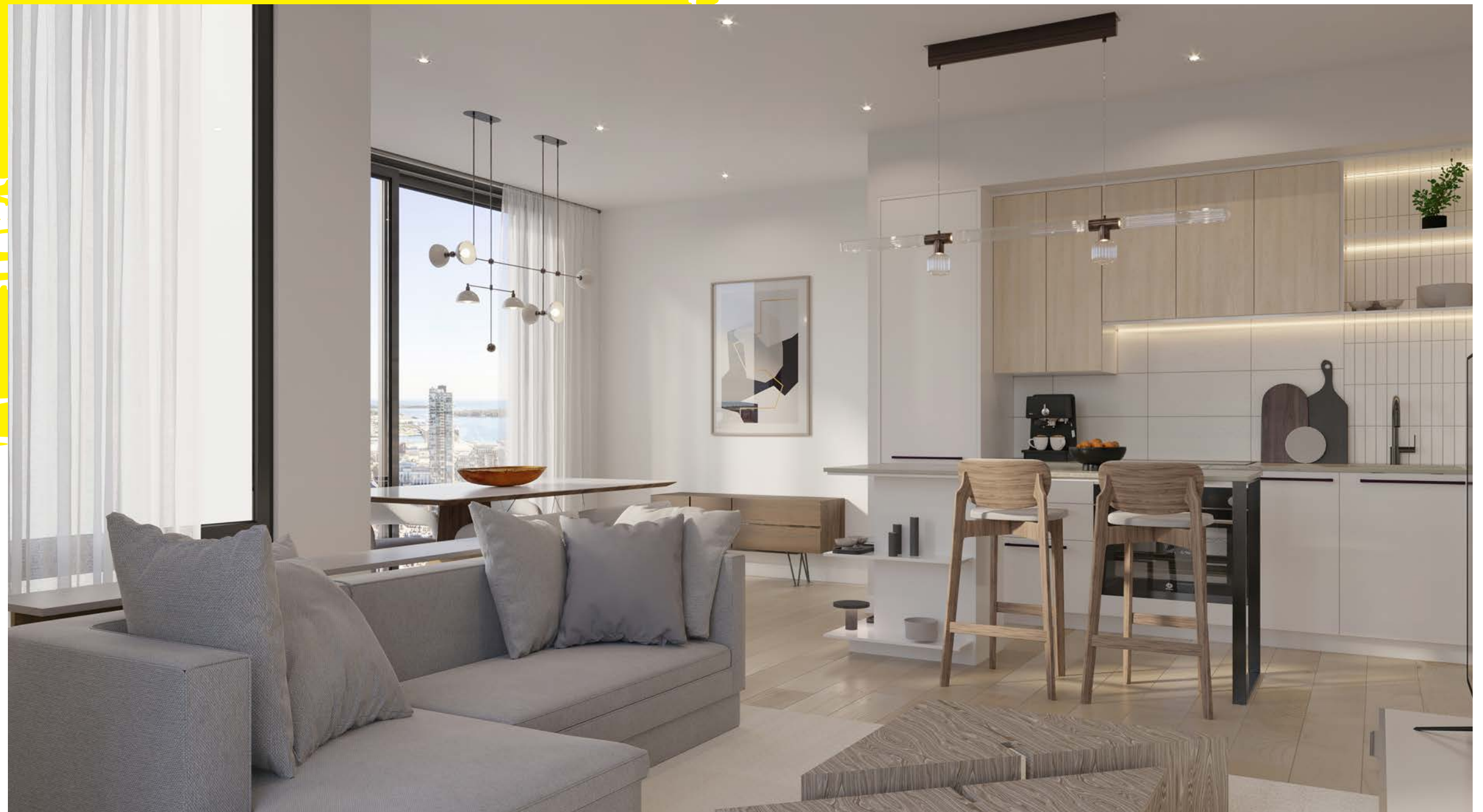

Suites maximize light and space; open-concept living with the city just outside your window.



Light-filled suites that offer easy solutions for furniture layouts against a backdrop of inspiring views.



Picasso, Toronto



Highbury Gardens, Whitby



181 East, North York



Four Generations of Building Tradition

Stafford is a fully diversified private property development company that has been involved in land development, construction and property management in Canada and the United States for more than 50 years. As one of Toronto's most experienced and innovative real estate development companies, **Stafford has earned a reputation for construction quality, beautiful designs and efficient living spaces** while consistently developing award winning projects on time and in accordance with the highest standards in the industry.



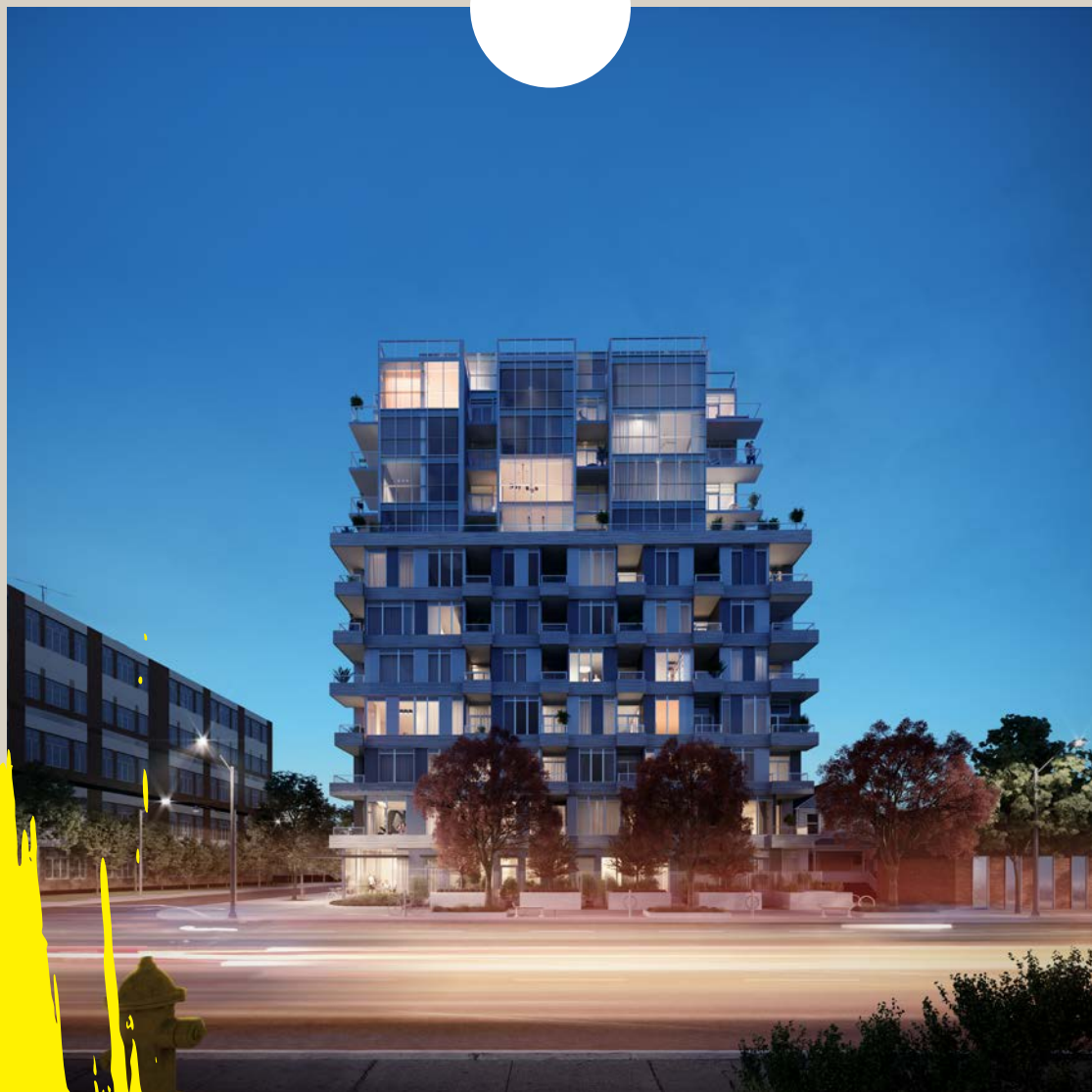

RAW is one of Toronto's most vibrant architectural and design studios. RAW focuses on understanding site opportunities and client-specific objectives in order to produce outstanding results. While our work ranges from Masterplans to private homes, we are best known for our mid-rise infill projects which can be found on many of Toronto's important streets. RAW is not a hierarchical corporation, we take an open-minded approach to design, encouraging a fluid and collaborative process. RAW is an enthusiastic young office with energetic and dedicated staff who bring playful contextually sensitive solutions to all types of interventions. We are a medium-sized design studio delivering creative responses to design challenges.

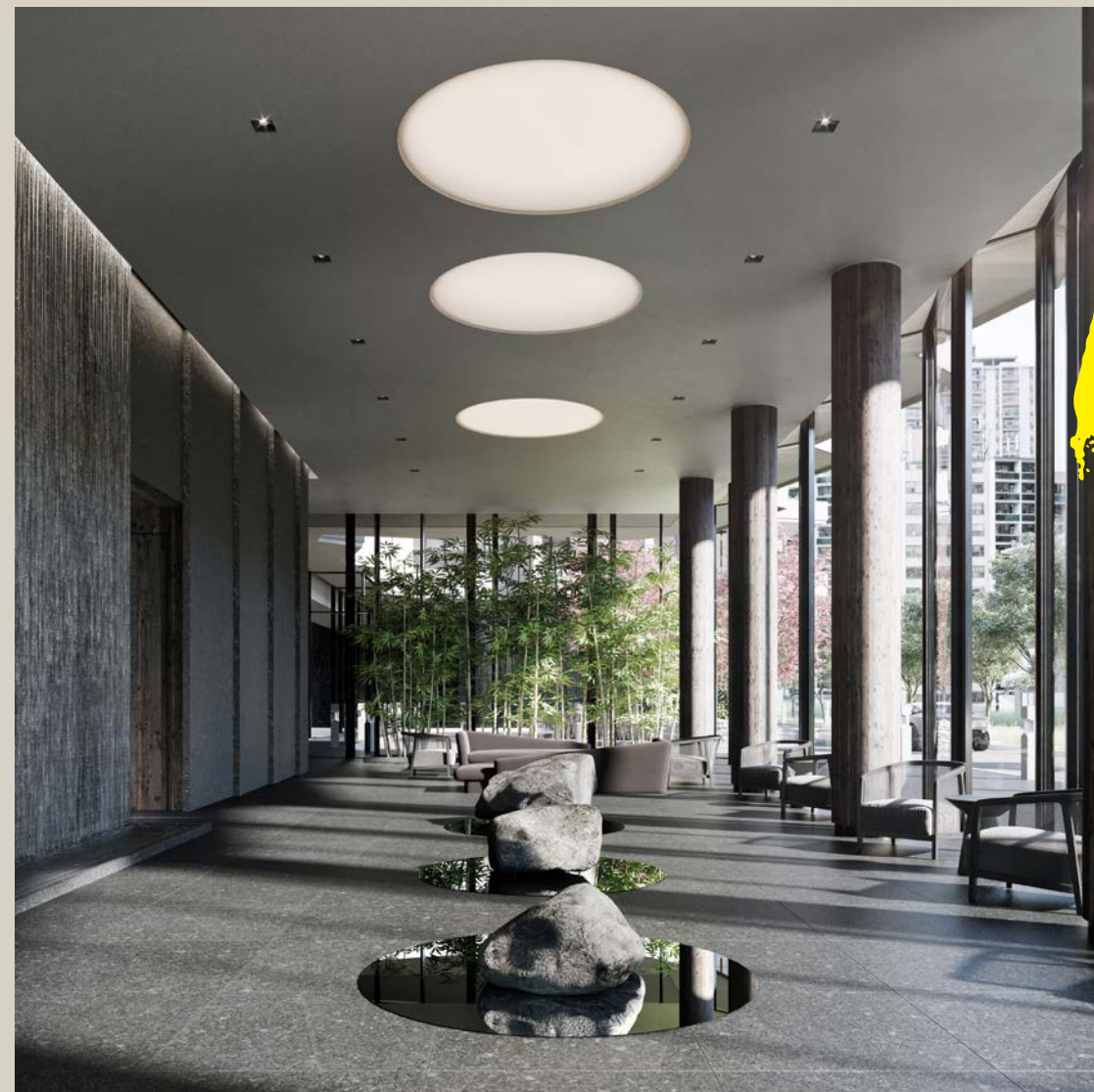

U31 is an award-winning interior architecture and design studio led by creative principals, Kelly Cray and Neil Jonsohn. The firm focuses on diverse residential, commercial and hospitality projects for clients across the globe, including luxury homes and large-scale mixed-use developments. With over twenty-five years of industry experience, U31 creates inspired, tailored and diverse designs that challenge convention and elevates the built environment.



INTIMATE,
INSPIRED AND
UNEXPECTEDLY
GRAND.

The Georgian

Renderings are artist's concept only. Furnishings are not included. Specifications are subject to change without notice. E.&O.E.

 **Stafford**[®]

The Georgian